

**Shower - Madison**

**Concealed thermostat with three function volume control - Durabress**

Article number: 36 427 977-09

- rotary diverter with volume control and shut-off function
- cover plate Ø 175 mm
- temperature control handle with safety limit stop at 38°C
- hot water temperature limiter, can be preset
- Fittings group as per DIN 4109: 1



Durabress

Miscellaneous items are required for this article.

Discontinued articles/items available to order until 31.12.9999

**Dimensional drawing**

mm [inches]

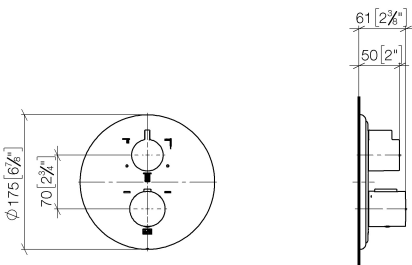

All details in mm / inch = mm x 0.0394



Shower - Madison

Concealed thermostat with three function volume control - Durabross

Article number: 36 427 977-09

### Flow rate chart

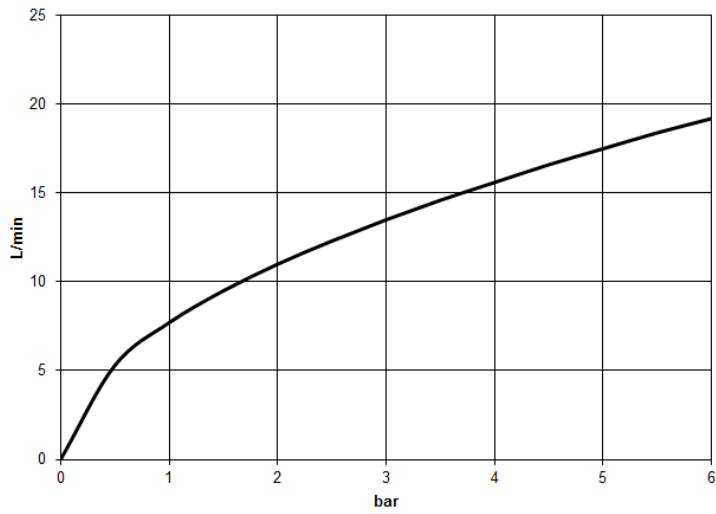



## Shower - Madison

Concealed thermostat with three function volume control - Durabross

Article number: 36 427 977-09

### Other finish variants



polished chrome  
36 427 977-00



platinum matt  
36 427 977-06



platinum  
36 427 977-08



brushed Durabross  
36 427 977-28



Dark Platinum matt  
36 427 977-99

Other finishes on request (x-tra Service)



35 427 970 90  
Concealed thermostat -

Shower - Madison

Concealed thermostat with three function volume control - Durabress

Article number: 36 427 977-09

Spare parts list

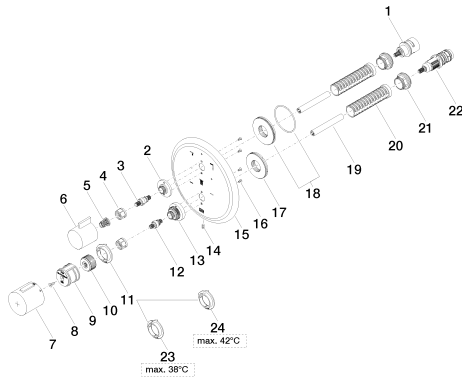

| No. | Item Number        | Name       | Quantity used |
|-----|--------------------|------------|---------------|
| 1   | 90 90 03 170 00 90 | diverter   | 1             |
| 2   | 09 12 12 053-09    | base       | 1             |
| 3   | 04 29 06 111 00-09 | spindle    | 1             |
| 4   | 09 23 30 023 90    | nut        | 2             |
| 5   | 09 12 12 002 90    | fixing cap | 1             |
| 6   | 09 20 67 006-09    | handle     | 1             |
| 7   | 90 17 33 017 00-09 | handle     | 1             |
| 8   | 09 30 30 124 90    | screw      | 1             |
| 9   | 09 12 12 052 90    | base       | 1             |
| 10  | 09 12 12 054 90    | base       | 1             |
| 11  | 09 28 10 187 90    | regulator  | 1             |
| 12  | 04 29 06 024 00-09 | spindle    | 1             |
| 13  | 09 12 12 051-09    | base       | 1             |
| 14  | 09 31 11 134 90    | pin        | 1             |
| 15  | 09 11 02 165-09    | plate      | 1             |
| 16  | 09 30 30 157 90    | screw      | 4             |
| 17  | 09 30 01 296 90    | disc       | 1             |
| 18  | 90 30 01 190 00 90 | disc       | 1             |
| 19  | 09 23 01 124 90    | sleeve     | 2             |
| 20  | 09 18 40 077 90    | sleeve     | 2             |
| 21  | 09 24 04 257 90    | nut        | 2             |
| 22  | 90 15 02 013 00 90 | cartridge  | 1             |
| 23  | 09 28 10 188 90    | regulator  | 1             |
| 24  | 09 28 10 189 90    | regulator  | 1             |