

Shower - Madison

Concealed thermostat with two function volume control - Durabronz

Article number: 36 426 977-09

- rotary diverter with volume control and shut-off function
- cover plate Ø 175 mm
- temperature control handle with safety limit stop at 38°C
- hot water temperature limiter, can be preset
- Fittings group as per DIN 4109: 1



Durabronz

Miscellaneous items are required for this article.

Discontinued articles/items available to order until 31.12.9999

Dimensional drawing

mm [inches]

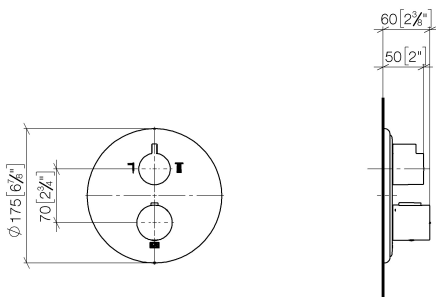

All details in mm / inch = mm x 0.0394



Shower - Madison

Concealed thermostat with two function volume control - Durabrass

Article number: 36 426 977-09

Flow rate chart

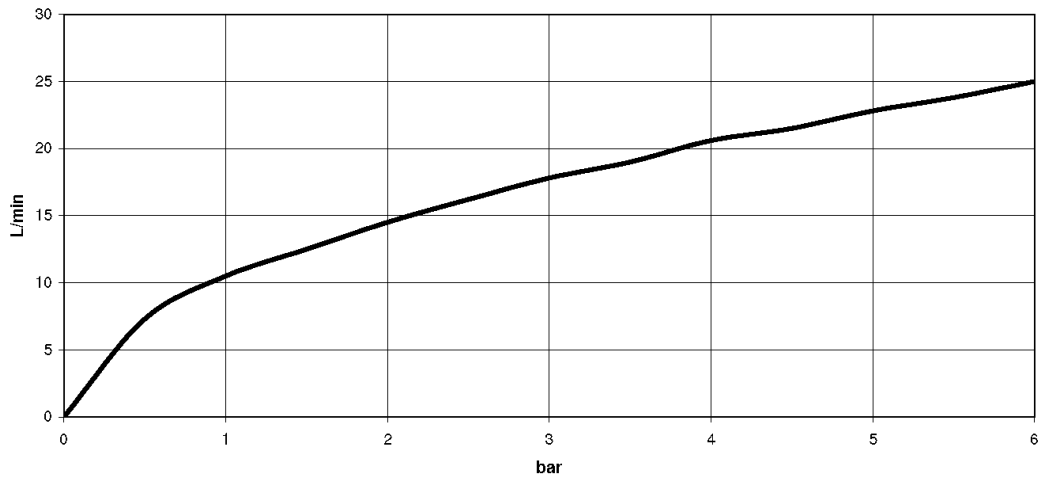



Shower - Madison

Concealed thermostat with two function volume control - Durabronz

Article number: 36 426 977-09

Other finish variants

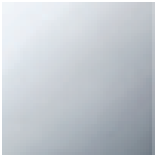

polished chrome
36 426 977-00



platinum matt
36 426 977-06



platinum
36 426 977-08

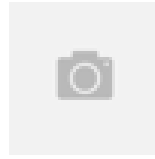

brushed Durabronz
36 426 977-28



Dark Platinum matt
36 426 977-99

Other finishes on request (x-tra Service)



35 425 970 90
Concealed thermostat -



35 426 970 90
Concealed thermostat with
built-in isolators -

Shower - Madison

Concealed thermostat with two function volume control - Durabrass

Article number: 36 426 977-09

Spare parts list

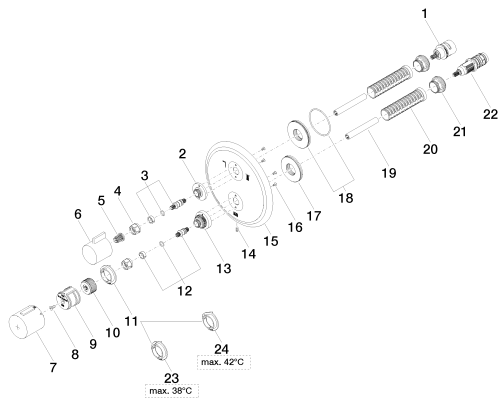

No.	Item Number	Name	Quantity used
1	90 90 03 163 00 90	diverter	1
2	09 12 12 053-09	base	1
3	04 29 06 111 00-09	spindle	1
4	09 23 30 023 90	nut	2
5	09 12 12 002 90	fixing cap	1
6	09 20 67 006-09	handle	1
7	90 17 33 017 00-09	handle	1
8	09 30 30 124 90	screw	1
9	09 12 12 052 90	base	1
10	09 12 12 054 90	base	1
11	09 28 10 187 90	regulator	1
12	04 29 06 024 00-09	spindle	1
13	09 12 12 051-09	base	1
14	09 31 11 134 90	pin	1
15	09 11 02 308-09	plate	1
16	09 30 30 157 90	screw	4
17	09 30 01 296 90	disc	1
18	90 30 01 190 00 90	disc	1
19	09 23 01 124 90	sleeve	2
20	09 18 40 077 90	sleeve	2
21	09 24 04 257 90	nut	2
22	90 15 02 013 00 90	cartridge	1
23	09 28 10 188 90	regulator	1
24	09 28 10 189 90	regulator	1